

356395

This contract provides for re-treatment of a structure and the repair of damages caused by wood destroying organisms within the limits stated in this contract.



SENTRICON\* SYSTEM SERVICE AGREEMENT  
DAMAGE REPAIR & RETREAT GUARANTEE  
for Subterranean Termites

Source Code: Creative

Cynthia Combs  
Account Name- First Last  
644 Sun Down Circle  
Service Address Apt/Bldg #  
St. Augustine FL 32080  
City State Zip Code  
904-463-6040  
Best Contact Number Other Phone

644 Sun Down Circle  
Billing Address Apt/Bldg #  
St. Augustine FL 32080  
City State Zip Code  
904-463-6040  
Billing Phone Office Phone  
cahrealty@aol.com  
Email Address

TYPE OF STRUCTURE:  RESIDENTIAL  COMMERCIAL  MULTI-UNIT- BLDGS. #: \_\_\_\_\_  
STRUCTURES FOR SERVICE:  MAIN DWELLING  OTHER: \_\_\_\_\_  
TYPE OF INITIAL TREATMENT:  POST-CONSTRUCTION  NEW CONSTRUCTION  OTHER: \_\_\_\_\_  
LOCATION OF NOTICE OF SERVICE:  N/A  ATTIC  CRAWL  OTHER: \_\_\_\_\_  
PURPOSE OF SERVICE:  PREVENTION  PRESUMPTIVE EVIDENCE  EXISTING INFESTATION

INITIAL INVESTMENT

Initial Cost.....\$ 0.00  
Other Fees.....\$ \_\_\_\_\_  
Sales Tax.....\$ \_\_\_\_\_  
TOTAL INITIAL COST.....\$ 0

METHOD OF PAYMENT:  Check  Cash  Credit Card  
Renewal Maintenance Fee \$227.00  
Renewal Frequency  Monthly  Quarterly  Annually

UPON RECEIVING FULL PAYMENT AND COMPLETING THE INITIAL SERVICE THE COMPANY WILL PROVIDE A DAMAGE REPAIR & RETREAT GUARANTEE FOR TERMITES AS SPECIFIED AND DESCRIBED IN THE PROVISIONS, TERMS AND CONDITIONS SET FORTH ON THE FRONT AND BACK OF THIS AGREEMENT, WHICH WILL PROVIDE A DETAILED EXPLANATION OF THE GUARANTEE ALONG WITH ALL DISCLAIMERS, LIMITATIONS, CONDITIONS OR EXCLUSIONS.

SERVICE PROVISIONS

NADER'S PEST RAIDERS (The Company) is authorized by Corteva Agriscience™, to install the Sentricon\* Colony Elimination System and conduct associated service and treatment protocols for customer. The Sentricon\* System allows for servicing bait treatment for subterranean termites with Recruit\* an insect growth regulator containing the active ingredient Noviflumuron. The Customer appreciates that subterranean termite control is not immediate. Specifically, control and/or colony elimination may take several months. Customer understands that the inherently "delayed" action of the insect growth regulator is necessary to defeat avoidance behavior by foraging subterranean termites. The Company shall provide the following termite control services to Customer under this agreement:

- 1. Initial inspection of applicable structures and grounds and installation of in-ground bait stations around the perimeter of the structure at the Company's discretion.
- 2. Servicing of stations by the Company Service Representatives, commencing with the installation of the system. All stations will be serviced within the guidelines as specified under the most current material label standards.
- 3. Application of Recruit\* termite bait in stations. The Company may install additional stations and/or modify existing stations at its discretion and in compliance with all label and labeling directions.
- 4. Periodically inform the Customer of any new or increased termite activity noted at any of the stations during any of the routine inspections.
- 5. Upon achieving colony elimination, the Company will provide for unlimited repairs of new subterranean termite damage as set forth in the provisions, terms and conditions of this agreement. The guarantee is effective immediately upon installation on structures which have no present or past termite activity or on those structures which receive a treatment specifically designed by the Company to control live termites directly, performed at or near the time of the installation of Sentricon stations.

As compensation for services rendered or to be rendered under this agreement, the Customer shall pay the Company an installation fee and maintenance fee, as specified, upon signing the agreement. This agreement and guarantee may be renewed for life by paying the annual Renewal Maintenance Fee on a consecutive basis. Failure to pay consecutive Renewal Maintenance Fees will render this agreement and guarantee null and void. After the first year, adjustments to the Renewal Maintenance Fee may be made annually by the Company giving the Customer a minimum of thirty days notice regarding the new rate. This guarantee is transferable to a subsequent owner provided that the Renewal Maintenance Fee is paid on a consecutive basis from the time of the initial installation.

Customer agrees not to move, open, handle or damage Sentricon\* stations, bait devices or any other parts of the system. Tampering with such components may compromise the efficacy of the system and shall constitute a basis for terminating this agreement. The Customer may be responsible for the cost of replacement or repair of any damaged or missing bait stations that were not damaged or removed by the Company and/or its agent. The bait stations and associated materials (Sentricon\* Components) provided by the Company are and shall remain the exclusive property of Corteva Agriscience™. Customer understands that he does not acquire any ownership interest or title to such components and that upon termination of this agreement for any cause whatsoever, the Company and/or Corteva Agriscience™ are hereby authorized to remove all such components.

The guarantee in this agreement is in lieu of all other guarantees and warranties, expressed and implied, including the warranties of merchantability and fitness for a particular purpose. The customer is entitled to a copy of any treatment specifications, customer preparation sheets, checklists and any applicable release forms. All specifications and special circumstances have been fully explained to me.

Nader's Pest Raiders

Date: 08/29/2023

Company Representative Service Center Manager  
193 San Marco Ave  
Company Address  
St. Augustine FL 32084  
City State Zip  
904-671-8240  
Company Phone

mike greens

TO THE PROPERTY OWNER OR PROPERTY MANAGER:

If this is a home solicitation you may cancel this agreement by providing written notice to the seller in person or by mail. This notice must indicate that you do not want the goods or services and must be delivered or postmarked before midnight of the third business day after you sign this agreement. If you cancel this agreement, the seller cannot keep any part of a cash down payment. You are entitled to and should receive an exact executed copy of this agreement. This agreement is contingent on the approval of the Service Center Manager.

By signing below, I hereby acknowledge that I have read and understand the Terms and Conditions stated on each page of this agreement.

Accepted By: \_\_\_\_\_ Date: 08/29/2023  
 Owner/Buyer  Authorized Agent

CE

LC-Other 2

2094FT

CONVERS OPUP

MDM \$25 MH \$10

## DAMAGE REPAIR AND RETREAT GUARANTEE FOR SUBTERRANEAN TERMITES

Subject to the Graph, Specifications, Service Provisions and the General Terms, Conditions, Limitations, Exclusions and Disclaimers listed herein, the Company issues this Damage Repair and Retreat Guarantee which provides repair for subterranean termite damage occurring after the original date of treatment as specified in section 5 under service provisions, provided however that live subterranean termites must be discovered in these areas, otherwise the damage will be considered old damage and not covered under this agreement and provided that:

- A. **Damage Repairs:** Said damage occurs within the confines of the foundation walls of the structure. All adjacent areas, unless expressly identified, including, but not limited to: decks components and supports, steps, stringer, hot tubs, cross tie walls and planters, lattice-wood facades and retaining walls which are expressly excluded from the Damage Repair Guarantee. Such areas outside the foundation walls and adjacent to the structure will be covered for retreatment only.
- B. **Siding, Cellulose and Conductive Conditions:** It is the Company's policy that the Customer remove all synthetic stucco (E.I.F.S.)<sup>\*\*</sup> or other siding materials that are below the outside grade level, remove or insulate all wood/cellulose materials that are in direct contact with the ground, correct all conducive conditions that would allow target pest survive above the soil and repair all existing damage.
- C. **Moisture Conditions:** It is the owner's responsibility to correct and repair moisture conditions in the structure that may allow target pest to survive in the structure without returning the soil. Moisture conditions include but are not limited to faulty plumbing, roof leaks, faulty gutters/downspouts and/or poor drainage. Because such conditions may render certain treatments ineffective, the Company will approve additional treatment, when necessary, and will assume liability for those areas after the Customer has completed corrective measures. In no instance will it be the Company's responsibility for the repair of damage where the above conditions are permitted to exist.
- D. **Claims:** All claims are reviewed and approved by the Company. No claim will be paid or reimbursement made to a Customer until a) The Company's personnel have had an opportunity to verify the evidence of Subterranean Termite Damage before any alteration or destruction; and b) the damage is either repaired by a authorized Company representative or agent, and/or approved for repair by such representative or agent.
- E. **Renewal Fees:** This Guarantee is renewed by the Company receiving payment of the Renewal Maintenance Fee on or before the annual Renewal Date. The Company reserves the right to increase the Renewal Maintenance Fee after the first year, by giving the guarantee holder a minimum thirty days notice of the new renewal rate. This guarantee is transferable to a subsequent owner at no cost, only with the expressed consent of the Company, provided that the Renewal Maintenance Fees are paid on a consecutive basis from the time of the initial installation/treatment. Transfer is further contingent upon the subsequent owner providing current owners contact information including name, phone number, email, billing information and other information deemed necessary to maintain proper service.

### GENERAL TERMS AND CONDITIONS LIMITATIONS, EXCLUSIONS AND DISCLAIMERS

1. **TREATMENT STANDARDS:** In order to immediately address a known subterranean termite infestation, the Customer may at his discretion, employ the Company to provide conventional subterranean termite treatment and/or spot treatment for the purpose of mitigating immediate subterranean termite damage. Except as specified such measures are neither necessary nor detrimental to the effectiveness of the Sentricon<sup>®</sup> System.
2. **NOTIFICATION REQUIREMENTS FROM THE CUSTOMER:** Although regular lawn and ornamental pesticide applications will not generally interfere with the efficacy of the system, as an additional precaution, the Company requests notification of the conduct of such pesticide control services during the effective date of this agreement. Unless otherwise indicated advance notification is not required under this paragraph.
3. **MONITORING STANDARDS:** Accordingly, during the term of this agreement the Company shall provide such additional treatment as may be reasonable and necessary to control and eradicate persistent subterranean termite infestation, it is specifically understood that a period of at least three months shall be allowed from date of installation before additional procedures will be required.
4. **SUBTERRANEAN TERMITE CONTROL:** This service agreement and guarantee pertains only to subterranean termites (including Formosan termites) and does not apply nor is it intended to be effective against other insect pests including but not limited to drywood termites or other wood destroying insects and organisms.
5. **ALTERNATIVE TREATMENT COMMITMENT:** If the Company, for any reason ceases to be authorized to install and/or service the Sentricon<sup>®</sup> System, the Company will:
  - a. so notify the Customer;
  - b. offer the Customer an alternative of either using a different form of subterranean termite treatment or terminate this agreement. (NOTE Conventional "liquid barrier" methods of termite control may not offer an effective means of controlling certain termite infestations in certain structures. In such event the Company may not be able to offer a different form of termite protection).
  - c. if the Customer and the Company agree on a different form of termite control or treatment the Company shall give the Customer a pro rata credit for services paid for but not yet received which may be applied against conventional subterranean termite treatment costs;
  - d. if the Customer elects to discontinue this agreement or if the Company cannot offer an effective different form of termite control, the Company shall return to the Customer an amount equal to the fee paid for services not yet received.
6. **PREMISES MADE AVAILABLE FOR INSPECTION:** The Company reserves the right to conduct additional inspections of the premises on an as needed basis without charge to Customer. The Customer agrees provide complete access to the property during normal business hours at the Company's request.
7. **STRUCTURAL MODIFICATIONS:** In the event the owner structurally or cosmetically modifies, alters or otherwise changes the structure hindering or obstructing a visual inspection after the date of the initial treatment, this agreement will terminate unless the owner has notified the Company in advance in writing of any such alterations or modifications and received approval from the Company for the work proposed. Alterations or modifications that may prevent an area from being inspected could include, but are not limited to, additions, finishing of unfinished areas, plumbing changes, addition of spray foam, encapsulation or rigid board insulation, latticed wood, wood flooring, decks, new landscaping and /or any movement of soil next to the foundation. The owner will be responsible for any additional treatment required and the renewal maintenance fee may also be adjusted.
8. **REMOVED OR DAMAGED STATIONS:** Customer shall promptly advise the Company in the event that any of the monitoring/bait stations are damaged or removed for any reason so as to facilitate the repair or replacement of the same.
9. **LIABILITY LIMITATIONS:** The Company's liability under this agreement shall be terminated should the Company be prevented from fulfilling its responsibilities under the terms of the agreement by reasons of acts of war, natural disaster, or the failure of Customer to provide cooperation and access as required under this agreement.
10. **NEXT GENERATION MATERIALS:** The Company reserves the right to substitute any upgraded or next generational ingredients for Recruit<sup>®</sup> should they become available. The most current label standards for upgraded or next generation products shall take precedence.
11. **AMENDMENTS:** This agreement and guarantee constitute a complete recitation of all understandings and responsibilities between the parties and may not be altered or changed without the prior written consent of both parties. Any changes must be in the form of an addendum and approved in writing by the COMPANY. Alterations and changes made directly to this agreement will void the guarantee.
12. **VALIDATION OF GUARANTEE:** This agreement is not valid unless actual work is performed and paid in full. A service fee of 1 1/2% interest may be added to the unpaid balance over 30 days. If Customer fails to pay for services this agreement shall terminate without privilege of reinstatement and the Company shall be released from all liability hereunder. If collection becomes necessary the Customer agrees to pay all costs of collection including reasonable attorney fees.
13. **DISCLAIMER FOR INSPECTION OF MOLD:** Customer agrees that the Company has not inspected for and is not qualified to inspect any surfaces, air or any other portion or member of the structure covered by this agreement for the presence of molds, mold-like conditions or non-wood destroying fungi (including but not limited to Stachybotrys atra), and that the Company has no liability for inspection of the structure for same. The inspection for, evaluation of or treatment for the presence of mold, mold-like conditions or non-wood destroying fungi should be referred to the appropriate mold professional or certified industrial hygienist chosen by the Customer.
14. **DISCLAIMER FOR TREATMENT OF MOLD:** Customer agrees that the treatment contemplated by this agreement with the Company does not treat for or prevent mold mold-like conditions or non-wood destroying fungi (including but not limited to Stachybotrys atra). Accordingly, Customer, on behalf of himself/herself his/her heirs, successors or assign agrees that the Company shall have no liability for any personal injury or property damage arising from any exposure of any person to said molds, mold-like conditions or non-wood destroying fungi (including but not limited to Stachybotrys atra). Any inspection for, evaluation of or treatment of molds, mold-like conditions or non-wood destroying fungi should be referred to and handled by an appropriate mold professional or certified industrial hygienist chosen by the Customer.
15. **ARBITRATION:** It is understood and agreed that this is the entire agreement of the parties, and that the Company and the Customer are bound only by the terms and conditions of this agreement and not by any other representation, warranty or agreement, oral or otherwise. The Customer and the Company agree that any controversy or claim between them shall be settled by private, binding arbitration or, if agreeable to the parties, mediation, to be followed by arbitration should mediation not result in a settlement of the dispute. The parties shall submit their claim to a private arbitration or mediation provider. Any arbitrator shall have no authority to award any damages other than the actual monetary loss sustained. In no event shall the arbitrator have the authority to award any punitive or exemplary damages, treble or multiplied damages under any law or theory, damages for mental or emotional distress of any kind, or any costs or attorney's fees incurred by the parties.
16. **INSURANCE:** The COMPANY is fully insured for providing services described in this Agreement. Information about this coverage is available from the COMPANY.

**The Removal of the bait or baiting system may result in a lack of termite protection.**

<sup>†</sup>Trademark of Corteva Agriscience<sup>™</sup>

<sup>\*\*</sup>Exterior Insulation Finish Systems



WILTON SIMPSON  
COMMISSIONER

Florida Department of Agriculture and Consumer Services  
Division of Agricultural Environmental Services

**CONSUMER NOTICE FORM**

Rule 5E-14.105, F.A.C.

A pest control company must give you a written contract prior to any treatment of each wood-destroying organism. It is very important that you read and understand the contract you are signing. The pest control company is only obligated to follow the terms of the contract you have signed, regardless of other statements by the company or salesperson. (Note: Contracts for treatment for new construction can be issued to the builder and provided to you at closing).

**BASIC REQUIREMENTS FOR CONTRACTS**

- The contract must state the common name of the wood-destroying organism to be controlled by the company (e.g. subterranean termite, powder post beetle). If the contract is for termite control, the contract must clearly state whether Formosan termites are covered or not.
- Some contracts do not include a treatment at the time the contract is issued, and that should be clearly stated. If a treatment is performed as part of the contract, the cost for the treatment must be stated. If the treatment is only for certain areas, the contract should clearly state that it is for "spot treatment" only.
- The contract must state if it is a retreatment only or a retreatment and repair contract. If it is a retreatment and repair contract, carefully read the sections of the contract that state when repairs will or will not be covered by the contract.

**REQUIREMENTS FOR STATING WHEN TREATMENT OR REPAIR WILL NOT BE COVERED BY THE CONTRACT**

- Repair contracts will not cover repairs from termite damage under every condition. The contract must state when retreatment or repair will be done, and conditions under which the company can refuse to retreat or repair.
- These conditions have to be stated and be under headings in the contract that are in bold print. Companies typically refuse repair or retreatment if the condition of the house is such that moisture or leaks result in termite infestation, or where siding makes it hard to see termite infestation

Examples of this are:

- Cracks in concrete slabs
- Wood or wall siding in contact with ground
- Plumbing leaks
- Leaks in the roof
- Water accumulating against side of house

The law does require that companies notify you if they see conditions which would void the repair promise and they have to give you a chance to correct the condition before voiding the contract or denying repair coverage.

- Contracts may have a condition that does not cover Formosan termite damage until a specific time period has passed. This means that if damage occurs during this period the company will not pay for repair.
- You have the right to compare contracts from other companies before signing a contract with a company. Choose the company that gives you the best contract options.
- If you have any questions about the terms of the contract, or concerns about the compliance history of the company with regard to pest control laws or regulations, contact the Department of Agriculture and Consumer Services at phone number: 850-617-7996 or email: [biircomplaints@fdacs.gov](mailto:biircomplaints@fdacs.gov).

I understand that I am entering into a contract with Nader's Pest Raiders (fill in company name) to provide wood-destroying organism(s) treatment, and I have read and understood the terms of the contract.

Cynthia Combs

Print Name of Consumer

Date: 08/29/2023

Signature of Consumer

Title: Property Owner or Authorized Agent

Jason Longo

Print Name of Pest Control Representative

Date: 08/29/2023

Signature of Pest Control Representative

Company: Arrow Exterminators



# TERMITE TREATMENT DETAIL



The Arrow Exterminators Family of Brands

Customer Name Cynthia Combs

Customer Address 644 Sun Down Circle City St. Augustine State FL Zip 32080

### Treatment Sold

- Sentricon- Approx # Stations 20 Price \$ 227.00
- Liquid Product \_\_\_\_\_ Price \$ \_\_\_\_\_
- Coring- # \_\_\_\_\_ Price \$ \_\_\_\_\_
- Above Ground Stations- # \_\_\_\_\_ Price \$ \_\_\_\_\_
- Other \_\_\_\_\_ Price \$ \_\_\_\_\_

### Customer Type

- |                                     |  |                        |           |
|-------------------------------------|--|------------------------|-----------|
| <input checked="" type="checkbox"/> | Any Current Customer                     | Sentricon PestPac Code | QD        |
| <input type="checkbox"/>            | New Construction                         |                        | QN        |
| <input type="checkbox"/>            | Real Estate Transaction                  |                        | QR        |
| <input type="checkbox"/>            | Converted from Active, Terminix, etc.    |                        | QT        |
| <input type="checkbox"/>            | Sentricon Reinstatement within 24 months |                        | RQ        |
| <input type="checkbox"/>            | Termite Renewal Upgrade                  |                        | TTE       |
| <input type="checkbox"/>            | Conversions > 400 LF                     |                        | QD or TTE |
| <input type="checkbox"/>            | New Customer                             |                        | None      |
| <input type="checkbox"/>            | Liquid Reinstatement                     |                        | None      |
| <input type="checkbox"/>            | Termite Renewal Conversion               |                        | None      |

### Structure Information

#### Application Type

- Curative
- Preventive

#### Treatment History

- Never
- < 5 years
- > 5 years
- Unknown

#### Size of Structure: 209

- Linear Feet
- Square Feet
- Cubic Feet

#### Residential

- Single Family
- Multi Family
- Other

#### Commercial

- Government
- Health Care
- Office
- Church
- Food Service
- School
- Other

#### Structure Type

- Slab
- Basement
- Crawl
- Garage

NOTE: Check all that apply.

Exception Form Required?  Yes  No

Home Evaluator Signature \_\_\_\_\_

Date: 8-29-23



# CONTROL SPECIFICATIONS

- Comprehensive Treatment
- Defined Treatment
- Sentricon® System



The Arrow Exterminators Family of Brands

Service Address: 644 Sun Down Circle City: St. Augustine State: FL Zip Code: 32080

<input type="checkbox"/> 1. Remove all cellulose debris from crawl space 	<input type="checkbox"/> 11. Drill & treat brick veneer voids 	<input type="checkbox"/> 21. Remove form boards 	<input type="checkbox"/> 31. Drill & treat stone foundation voids 
<input type="checkbox"/> 2. Haul cellulose debris from premises 	<input type="checkbox"/> 12. Treat inside perimeter of garage slab 	<input type="checkbox"/> 22. Rod & treat dirt fill from <input type="checkbox"/> Rear <input type="checkbox"/> Front <input type="checkbox"/> Side 	<input type="checkbox"/> 32. Drill & treat double brick foundation voids 
<input type="checkbox"/> 3. Treat soil adjacent to foundation <input type="checkbox"/> Trench <input type="checkbox"/> Rod 	<input type="checkbox"/> 13. Treat inside perimeter of garage by rodding from crawl 	<input type="checkbox"/> 23. Drill & treat concrete capping at foundation wall in crawl 	<input type="checkbox"/> 33. Drill & treat triple brick foundation voids 
<input type="checkbox"/> 4. Treat soil adjacent to foundation walls 	<input type="checkbox"/> 14. Drill & treat dirt filled area from above 	<input type="checkbox"/> 24. Wood application for: <input type="checkbox"/> Wood Borers <input type="checkbox"/> Powder Post Beetles 	<input type="checkbox"/> 34. Install Inspection Panel 
<input type="checkbox"/> 5. Treat soil adjacent to piers 	<input type="checkbox"/> 15. Treat fireplace or chimney voids 	<input type="checkbox"/> 25. Set wood supports on concrete pads # ____ 	<input type="checkbox"/> 35. Treat entrances in slab-bath tub and sewer lines 
<input type="checkbox"/> 6. Drill & treat voids in piers 	<input type="checkbox"/> 16. Drill & treat exterior slab that abuts structure 	<input type="checkbox"/> 26. Break ground contact on step stringers # ____ 	<input type="checkbox"/> 36. Drill & treat along partition wall 
<input type="checkbox"/> 7. Treat soil adjacent to pipes 	<input type="checkbox"/> 17. Treat Inside perimeter of slab from inside 	<input type="checkbox"/> 27. Treat inside perimeter of slab by rodding from outside 	<input checked="" type="checkbox"/> 37. Install Sentricon® with Always Active™ 
<input type="checkbox"/> 8. Drill & treat concrete block foundation voids 	<input type="checkbox"/> 18. Drill & treat concrete basement floors 	<input type="checkbox"/> 28. Install Vapor Barrier 	<input type="checkbox"/> 38. Install above ground stations with Always Active™ 
<input type="checkbox"/> 9. Treat foundation voids from above 	<input type="checkbox"/> 19. Treat expansion joints 	<input type="checkbox"/> 29. Install Auto Vents # ____ 	<input type="checkbox"/> 39. Treat areas for Drywood Termites 
<input type="checkbox"/> 10. Scrape off termite shelter tunnels 	<input type="checkbox"/> 20. Provide access to crawl space 	<input type="checkbox"/> 30. Prepare & install vent shields # ____ 	<input type="checkbox"/> 40. Prepare floor surface for drilling <input type="checkbox"/> Tile <input type="checkbox"/> Hardwood <input type="checkbox"/> Carpet <input type="checkbox"/> Linoleum 
<input type="checkbox"/> 41. <input type="checkbox"/> Install Core for Sentricon® with Always Active™ 	<input type="checkbox"/> Install alternative coring for above ground station with Always Active™ 	<input type="checkbox"/> 42. <input type="checkbox"/> Porch <input type="checkbox"/> Slab <input type="checkbox"/> Wall Void 	

## ADDITIONAL INFORMATION AND INSTRUCTIONS:

- Outside Power
- Take Generator
- Take Inspection Report
- Label To Customer
- Collect Payment: \$ \_\_\_\_\_

Other: \_\_\_\_\_



The Arrow Exterminators Family of Brands

# WOOD DESTROYING ORGANISM/ INSECT TREATMENT CHECKLIST

### Customer Information

Name: Cynthia Combs  
 Service Address: 644 Sun Down Circle  
 City: St. Augustine State: FL Zip: 32080  
 Phone #: 904-463-6040

### Company Information

Street Address: 193 San Marco Ave  
 City: St. Augustine State: FL Zip: 32084  
 Phone #: 904-671-8240

### Service Information

- Sentricon Installation only
- Comprehensive Liquid Treatment
- Wood treatment for Termites and/or Wood Boring Beetles
- Sentricon Installation w/limited liquid treatment
- Moisture Control
- Wood treatment for Wood Decay Fungi
- EP/IST (Defined treatment)
- Drywood Alternative Treatment
- Crawl Space Encapsulation

Home Evaluator  Service Professional

No one home at time of service

- Customers with E.I.F.S. or R.B.I. below grade have been advised that it is best practice to remediate the below grade conditions and that a secondary infestation could exist after treatment with a liquid or bait system installation.
- I have inquired whether any inhabitants are sensitive to odors or have respiratory conditions.
- Customer has been advised that there may be some odor associated with liquid treatments.
- I have inquired about the customer's source of water (well, cistern, spring, city water, etc.) and discussed with them the location of any sub-slab HVAC ducts, radiant heat lines, french drains, electrical lines and other treatment issues and have noted these on the treatment graph.
- I have inquired about customer installed service lines for items such as gas grills, outdoor kitchens, gas or electric lanterns, spas, pools, irrigation systems, outdoor buildings, etc. Any of the previous items have been noted on the treatment graph.
- I have inspected the interior and exterior of the structure to locate any hollow stoops or porches, encapsulated/sealed crawl spaces, cracks in slabs or foundation walls, or unusual construction elements and noted these on the treatment graph.
- At the completion of treatment, the structure will meet state treatment standards. Yes  or No . If no, appropriate state exception form signed by customer is attached to contract and graph.
- I have requested Utility Marking as required by appropriate local and/or state regulations (Bait systems only) and marking has been scheduled. Date Scheduled: 8-29-23 Expiration Date: 9-29-23 Reference #: 241302064
- I have performed a visual inspection for utility markings prior to any power augering or concrete/asphalt coring.
- All vertical drill holes have been plugged and patched to company standards.
- I have inspected the entire structure. There was no spillage of product during the application procedure. I have cleaned and swept-up the treatment areas and left the property in a neat and orderly fashion.
- All Sentricon stations are properly seated and flush with the surrounding grade.

Date of Completion: 9/11/23 Time In: \_\_\_\_\_  AM  PM Time Out: \_\_\_\_\_  AM  PM

Target Pest(s):	<u>1</u>				
Product(s) Applied:	<u>220</u>				
Method(s) of Application:	<u>37</u>				

### Sentricon

Number of Stations Installed: 14  
 Recruit AG Stations Installed: \_\_\_\_\_  
 Location(s) of AG Stations: \_\_\_\_\_

Area Treated	Linear Footage	Rate of Application	Per Foot of Depth	Total Gallons Used
Slab	_____	4 gal/10 LF	_____	_____
Exterior Trench	_____	4 gal/10 LF	_____	_____
Interior Trench	_____	4 gal/10 LF	_____	_____
Veneer	_____	2 gal/10 LF	N/A	_____
Block Voids	_____	2 gal/10 LF	N/A	_____
Piers	_____	per each	N/A	_____
Filled Porch	_____	4 gal/10 LF	_____	_____
Total	_____			_____

### Wood Treatment

Corrective  Preventative

Stud Wall Application: LNFT: \_\_\_\_\_ Height in inches: \_\_\_\_\_  
 Sub-floor Application: SQFT of Floor Space: \_\_\_\_\_  
 Rate of Application: \_\_\_\_\_  
 Dilution Rate: \_\_\_\_\_  
 Amount Used: \_\_\_\_\_

### Service Professional Comments:

\_\_\_\_\_

Brian Combs 9/11/23 56198374  
 Service Professional Signature Date State ID #

Home Evaluator Signature Date State ID #

Manager Signature Date

The work has been explained and performed to my satisfaction. I have received a copy of the Service Agreement, Treatment Specification Form, this Completion Certificate, and all other associated documents.

Customer Signature Date



# INSPECTION GRAPH

Date: 08/29/2023

Customer Name: Cynthia Combs Phone: 904-463-6040 Email: cahrealty@aol.com  
Service Address: 644 Sun Down Circle City: St. Augustine State: FL Zip: 32080

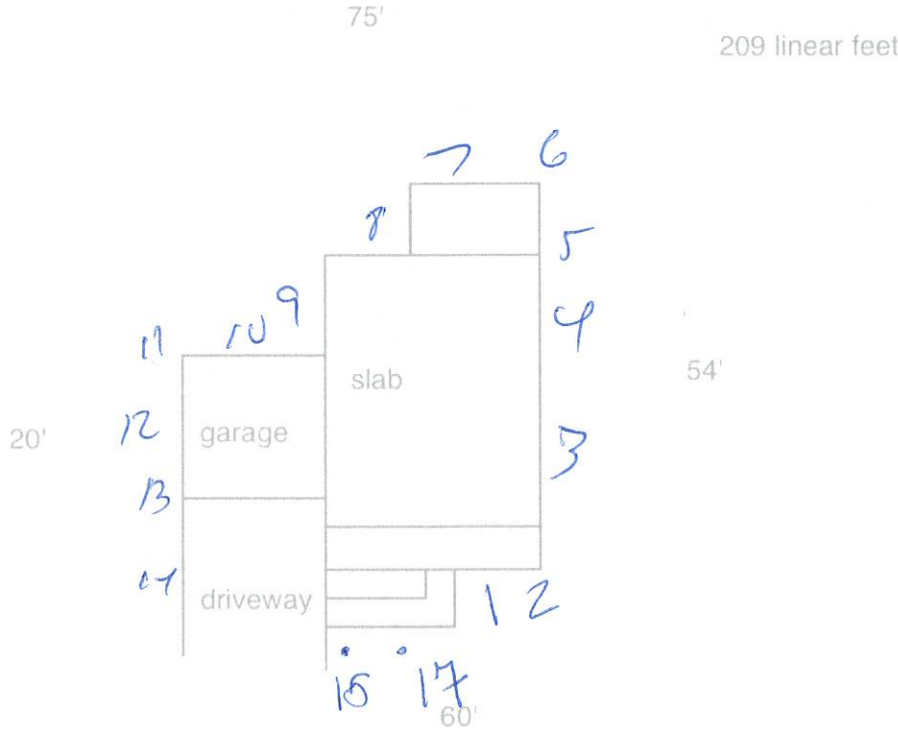

- FOUNDATION WALLS:**  Block  Poured  Other: \_\_\_\_\_
- EXTERIOR CLADDING:**  Brick  Stucco  Siding  Other: \_\_\_\_\_
- CONSTRUCTION TYPE:**  Finished Basement  Unfinished Basement  Floating Slab  Supported Slab
- Monolithic Slab  Crawl  Pier & Beam

Treatment Date: \_\_\_\_\_ PRODUCT: \_\_\_\_\_ % \_\_\_\_\_ Label Provided?  YES

**KEY:** ACTIVE INFESTATION = **A** SUBTERRANEAN TERMITES = **ST** DRYWOOD TERMITES = **DT**  
 WOOD BORERS = **WB** POWDER POST BEETLES = **PPB** \*WOOD DECAY FUNGI = **WDF**  
 \*MOISTURE CONDITION = **M** PREVIOUS INFESTATION = **P** BATH TRAP = **B**  
 POSSIBLE HIDDEN DAMAGE = **PHD** EXISTING VISIBLE DAMAGE = **X** INACCESSIBLE AREAS = **\***  
 WOOD TO GROUND CONTACT = **WGC** INADEQUATE VENTILATION = **IV** STANDING WATER = **SW**  
 CELLULOSE DEBRIS = **CD** \*Moisture Meter Readings Required

INSPECTOR'S STATEMENT LOCATION OF VISIBLE INFESTATION: \_\_\_\_\_

Signature of Certified Operator or Technician Completing Estimate \_\_\_\_\_ License/Registration Number JE208690 CONSUMER INFORMATION PROVIDED: Yes  No

## CUSTOMER SERVICE INFORMATION & PRECAUTIONS

If liquid treatment was required and was performed at the time of this visit, please review and follow the instructions below. If you have any questions or concerns, please contact your local office.

1. **IF YOU HAVE CRAWL SPACE CONSTRUCTION:** If the air circulation system is located in the crawl space, it has been turned off during the treatment process. Please allow the system to remain off until all treatment materials have been absorbed into the soil.
2. **IF YOU DETECT LEAKAGE OF TREATMENT MATERIALS:** All treatment products must be cleaned up by an authorized personnel and according to the company's spill control procedures. Please notify the company if you discover leakage of treatment materials in non-target locations. Humans & pets should be removed from the structure and not re-enter area(s) until the clean-up procedure has been completed.
3. **IF YOU FIND TREATMENT HOLES THAT ARE NOT RE-SEALED:** All treatment holes in slabs or interior areas must be re-sealed with non-cellulose material. Please notify the company if you notice any treatment holes are not re-sealed!
4. **NO CONTACT WITH TREATED AREAS:** Do not allow unattended persons, children, or pets to touch, enter or reside, sleep or feeding, to contact or enter treated area(s) until dry.
5. **VENTILATION PRIOR TO RE-OCCUPYING:** Vacate & keep area(s) closed up to 30 minutes after treatment, then ventilate area(s) for up to 2 hours before re-occupying.

**WE ARE COMMITTED TO PROVIDE YOU WITH THE QUALITY SERVICE THAT YOU DESERVE AND EXPECT. WE APPRECIATE YOUR BUSINESS.**

#	Product Name	Active Ingredient	EPA Reg. #	Method of Application / Specific Area
110	Airtrol	Chlorantraniliprole 0.55%	352-528	Remove all wall base debris from crawl space and adjacent to foundation
120	Alpine Ant & Termite Foam	Disdelturan 0.025%	490-528	Treat soil adjacent to foundation walls
130	Bora-Care 2 to 1 Solution 1.6%	Sodium Octaborate Tetrahydrate	64405-1	Soil & treat voids in pipes
140	Bora-Care 1 to 1 Solution 1.7%	Disdelturan Octaborate Tetrahydrate	64405-1	Treat soil adjacent to pipes
150	Bora-Care 1 to 1 Solution 1.7%	Disdelturan Octaborate Tetrahydrate	64405-1	Treat soil adjacent to pipes
170	Proterra 75	Imidacloprid 0.6%	432-1332	Treat termite infestation voids from edges
180	Proterra 75	Imidacloprid 0.6%	432-1332	Sealage of termite shelter tunnels
190	Proterra Prosectrol	Imidacloprid 0.05%	432-1334	Soil & treat back sewer voids
200	Proterra Prosectrol	Imidacloprid 0.05%	432-1334	Treat inside perimeter of concrete slab
210	Prosectrol 75 granulation	Nothoflufenor 0.5%	32710-654	Sealage of back sewer pipe for termite
220	Prosectrol HD 150 granulation	Nothoflufenor 0.5%	32710-654	Drill & treat: fill treated area from above
230	Palstar Prosectrol	Deltamethrin 0.2%	278-3206	Soil & treat exterior slab that abuts structure
240	Palstar Professional	Deltamethrin 0.2%	278-3206	Soil & treat exterior slab that abuts structure
250	Palstar Prosectrol 10%	Disdelturan Octaborate tetrahydrate	64405-1	Treat inside perimeter of slab from inside
270	Terminix 317	Piperonyl Butoxide	499-546	Treat equipment joints
280	Terminix 4E	Piperonyl Butoxide	7269-325	Remove termite barriers
290	Terminix 4E	Piperonyl Butoxide	7269-325	Back treat soil fill
300	Terminix 4E 25	Piperonyl Butoxide	7269-325	Back treat concrete foundation walls
310	Terminix 4E	Piperonyl Butoxide	7269-325	Back treat concrete foundation walls
320	Terminix 4E	Piperonyl Butoxide	7269-325	Back treat concrete foundation walls
330	Terminix 4E 25	Piperonyl Butoxide	7269-325	Back treat concrete foundation walls
340	Terminix 4E	Piperonyl Butoxide	7269-325	Back treat concrete foundation walls
350	Terminix 4E	Piperonyl Butoxide	7269-325	Back treat concrete foundation walls
360	Terminix 4E	Piperonyl Butoxide	7269-325	Back treat concrete foundation walls
370	Terminix 4E	Piperonyl Butoxide	7269-325	Back treat concrete foundation walls
380	Terminix 4E	Piperonyl Butoxide	7269-325	Back treat concrete foundation walls
390	Terminix 4E	Piperonyl Butoxide	7269-325	Back treat concrete foundation walls
400	Terminix 4E	Piperonyl Butoxide	7269-325	Back treat concrete foundation walls
410	Terminix 4E	Piperonyl Butoxide	7269-325	Back treat concrete foundation walls
420	Terminix 4E	Piperonyl Butoxide	7269-325	Back treat concrete foundation walls
430	Terminix 4E	Piperonyl Butoxide	7269-325	Back treat concrete foundation walls
440	Terminix 4E	Piperonyl Butoxide	7269-325	Back treat concrete foundation walls
450	Terminix 4E	Piperonyl Butoxide	7269-325	Back treat concrete foundation walls
460	Terminix 4E	Piperonyl Butoxide	7269-325	Back treat concrete foundation walls
470	Terminix 4E	Piperonyl Butoxide	7269-325	Back treat concrete foundation walls
480	Terminix 4E	Piperonyl Butoxide	7269-325	Back treat concrete foundation walls
490	Terminix 4E	Piperonyl Butoxide	7269-325	Back treat concrete foundation walls
500	Terminix 4E	Piperonyl Butoxide	7269-325	Back treat concrete foundation walls
510	Terminix 4E	Piperonyl Butoxide	7269-325	Back treat concrete foundation walls
520	Terminix 4E	Piperonyl Butoxide	7269-325	Back treat concrete foundation walls
530	Terminix 4E	Piperonyl Butoxide	7269-325	Back treat concrete foundation walls
540	Terminix 4E	Piperonyl Butoxide	7269-325	Back treat concrete foundation walls
550	Terminix 4E	Piperonyl Butoxide	7269-325	Back treat concrete foundation walls
560	Terminix 4E	Piperonyl Butoxide	7269-325	Back treat concrete foundation walls
570	Terminix 4E	Piperonyl Butoxide	7269-325	Back treat concrete foundation walls
580	Terminix 4E	Piperonyl Butoxide	7269-325	Back treat concrete foundation walls
590	Terminix 4E	Piperonyl Butoxide	7269-325	Back treat concrete foundation walls
600	Terminix 4E	Piperonyl Butoxide	7269-325	Back treat concrete foundation walls
610	Terminix 4E	Piperonyl Butoxide	7269-325	Back treat concrete foundation walls
620	Terminix 4E	Piperonyl Butoxide	7269-325	Back treat concrete foundation walls
630	Terminix 4E	Piperonyl Butoxide	7269-325	Back treat concrete foundation walls
640	Terminix 4E	Piperonyl Butoxide	7269-325	Back treat concrete foundation walls
650	Terminix 4E	Piperonyl Butoxide	7269-325	Back treat concrete foundation walls
660	Terminix 4E	Piperonyl Butoxide	7269-325	Back treat concrete foundation walls
670	Terminix 4E	Piperonyl Butoxide	7269-325	Back treat concrete foundation walls
680	Terminix 4E	Piperonyl Butoxide	7269-325	Back treat concrete foundation walls
690	Terminix 4E	Piperonyl Butoxide	7269-325	Back treat concrete foundation walls
700	Terminix 4E	Piperonyl Butoxide	7269-325	Back treat concrete foundation walls
710	Terminix 4E	Piperonyl Butoxide	7269-325	Back treat concrete foundation walls
720	Terminix 4E	Piperonyl Butoxide	7269-325	Back treat concrete foundation walls
730	Terminix 4E	Piperonyl Butoxide	7269-325	Back treat concrete foundation walls
740	Terminix 4E	Piperonyl Butoxide	7269-325	Back treat concrete foundation walls
750	Terminix 4E	Piperonyl Butoxide	7269-325	Back treat concrete foundation walls
760	Terminix 4E	Piperonyl Butoxide	7269-325	Back treat concrete foundation walls
770	Terminix 4E	Piperonyl Butoxide	7269-325	Back treat concrete foundation walls
780	Terminix 4E	Piperonyl Butoxide	7269-325	Back treat concrete foundation walls
790	Terminix 4E	Piperonyl Butoxide	7269-325	Back treat concrete foundation walls
800	Terminix 4E	Piperonyl Butoxide	7269-325	Back treat concrete foundation walls
810	Terminix 4E	Piperonyl Butoxide	7269-325	Back treat concrete foundation walls
820	Terminix 4E	Piperonyl Butoxide	7269-325	Back treat concrete foundation walls
830	Terminix 4E	Piperonyl Butoxide	7269-325	Back treat concrete foundation walls
840	Terminix 4E	Piperonyl Butoxide	7269-325	Back treat concrete foundation walls
850	Terminix 4E	Piperonyl Butoxide	7269-325	Back treat concrete foundation walls
860	Terminix 4E	Piperonyl Butoxide	7269-325	Back treat concrete foundation walls
870	Terminix 4E	Piperonyl Butoxide	7269-325	Back treat concrete foundation walls
880	Terminix 4E	Piperonyl Butoxide	7269-325	Back treat concrete foundation walls
890	Terminix 4E	Piperonyl Butoxide	7269-325	Back treat concrete foundation walls
900	Terminix 4E	Piperonyl Butoxide	7269-325	Back treat concrete foundation walls
910	Terminix 4E	Piperonyl Butoxide	7269-325	Back treat concrete foundation walls
920	Terminix 4E	Piperonyl Butoxide	7269-325	Back treat concrete foundation walls
930	Terminix 4E	Piperonyl Butoxide	7269-325	Back treat concrete foundation walls
940	Terminix 4E	Piperonyl Butoxide	7269-325	Back treat concrete foundation walls
950	Terminix 4E	Piperonyl Butoxide	7269-325	Back treat concrete foundation walls
960	Terminix 4E	Piperonyl Butoxide	7269-325	Back treat concrete foundation walls
970	Terminix 4E	Piperonyl Butoxide	7269-325	Back treat concrete foundation walls
980	Terminix 4E	Piperonyl Butoxide	7269-325	Back treat concrete foundation walls
990	Terminix 4E	Piperonyl Butoxide	7269-325	Back treat concrete foundation walls
1000	Terminix 4E	Piperonyl Butoxide	7269-325	Back treat concrete foundation walls

Trademark of Corixa Agriculture

The following pertains to any graph accompanying this document.

### SCOPE OF GRAPH REPORT Graph refers to and is part of the specified Service Agreement

1. The graph report is a document prepared by the company's trained and qualified personnel and is not a warranty or guarantee of any kind. It is a report of the company's findings and conclusions based on the information provided to the company and the results of the inspection. It is not a structural damage report nor is it a warranty as to the absence of wood destroying organisms or damage. It will not reveal all possible areas of damages or infestations. It should be assumed that there could be hidden damages or infestations. A structural engineer or professional qualified in structural repairs should be sought to determine the degree of damages or repairs should this report indicate active infestation, visible evidence of prior infestation and/or visible damages. The Company's personnel are not trained to make such determinations regarding structural damages.
2. The graph report is a document prepared by the company's trained and qualified personnel and is not a warranty or guarantee of any kind. It is a report of the company's findings and conclusions based on the information provided to the company and the results of the inspection. It is not a structural damage report nor is it a warranty as to the absence of wood destroying organisms or damage. It will not reveal all possible areas of damages or infestations. It should be assumed that there could be hidden damages or infestations. A structural engineer or professional qualified in structural repairs should be sought to determine the degree of damages or repairs should this report indicate active infestation, visible evidence of prior infestation and/or visible damages. The Company's personnel are not trained to make such determinations regarding structural damages.
3. The graph report is a document prepared by the company's trained and qualified personnel and is not a warranty or guarantee of any kind. It is a report of the company's findings and conclusions based on the information provided to the company and the results of the inspection. It is not a structural damage report nor is it a warranty as to the absence of wood destroying organisms or damage. It will not reveal all possible areas of damages or infestations. It should be assumed that there could be hidden damages or infestations. A structural engineer or professional qualified in structural repairs should be sought to determine the degree of damages or repairs should this report indicate active infestation, visible evidence of prior infestation and/or visible damages. The Company's personnel are not trained to make such determinations regarding structural damages.
4. The graph report is a document prepared by the company's trained and qualified personnel and is not a warranty or guarantee of any kind. It is a report of the company's findings and conclusions based on the information provided to the company and the results of the inspection. It is not a structural damage report nor is it a warranty as to the absence of wood destroying organisms or damage. It will not reveal all possible areas of damages or infestations. It should be assumed that there could be hidden damages or infestations. A structural engineer or professional qualified in structural repairs should be sought to determine the degree of damages or repairs should this report indicate active infestation, visible evidence of prior infestation and/or visible damages. The Company's personnel are not trained to make such determinations regarding structural damages.

### NOTICE TO THE PROPERTY OWNER/CUSTOMER

This graph report is not a structural damage report nor is it a warranty as to the absence of wood destroying organisms or damage. It will not reveal all possible areas of damages or infestations. It should be assumed that there could be hidden damages or infestations. A structural engineer or professional qualified in structural repairs should be sought to determine the degree of damages or repairs should this report indicate active infestation, visible evidence of prior infestation and/or visible damages. The Company's personnel are not trained to make such determinations regarding structural damages.



The Arrow Exterminators Family of Brands

Customer Acknowledgement Form

I, Cynthia Combs, have met with Nader's Pest Raiders and been made aware of my current termite service agreement stipulations relating to the "General Terms and Conditions, Limitations, Exclusions, and Disclaimers." I am aware that modifying the structure with encapsulations, spray foam, rigid board, and/or sealing in any manner prevents proper inspection and/or treatment. I understand it is my responsibility to correct these modifications in accordance with the guidance I have been provided by Nader's Pest Raiders. I understand that once these corrections have been made, the structure must be inspected and verified by an Nader's Pest Raiders representative to ensure it meets our minimum qualifications. I further acknowledge that if the recommended corrections are not corrected in a timely manner, my termite service agreement with Nader's Pest Raiders may be canceled.

CC

Customer Signature

Cynthia Combs

Customer Printed Name

644 Sun Down Circle, St. Augustine, FL 32080

Address

08/29/2023

Date