

VICINITY MAP NOT TO SCALE

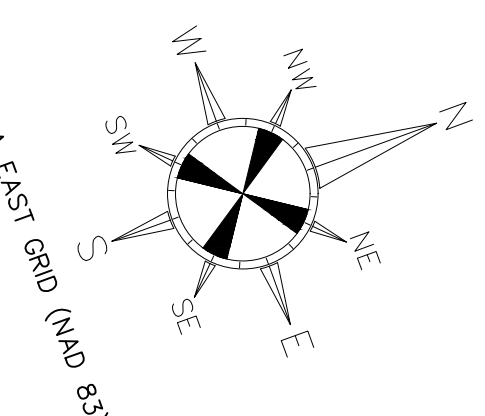

**LEGEND:**

	TELEPHONE JUNCTION BOX
	SIGN
	WATER VALVE
	GAS VALVE
	STORM SEWER MANHOLE
	OVERHEAD UTILITY POLE
	LIGHT POLE
	HYDRANT
	WATER METER
	TELEPHONE MANHOLE
	UNDERGROUND GAS LINE
	UNDERGROUND SEWER LINE
	UNDERGROUND TELEPHONE LINE
	OVERHEAD POWER LINE
	STORM DRAIN
	REINFORCED CONCRETE PIPE
	REBAR SET
	CONCRETE MONUMENT FOUND
	IRON PIPE FOUND
	IRON REBAR FOUND
	AXLE FOUND

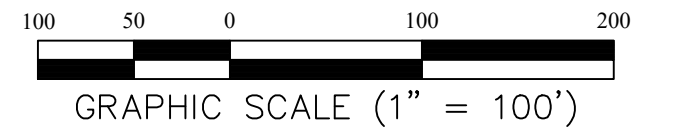

- NOTE:**
1. Restricted Access along frontage is based on sight distance requirements. If conditions change and adequate sight distance can be provided, access can be allowed in these areas.
  2. Each lot will only be allowed one driveway unless written approval is given by Columbia County Traffic Engineering.
  3. Adequate sight distance will need to be shown for all driveways upon submittal of a Land Disturbance Permit.

**UTILITY NOTE:**  
 UNUTILIZED WATER OR SEWER SERVICES TO BE ABANDONED PER COLUMBIA COUNTY STANDARDS.

WE HEREBY CERTIFY THAT WE ARE THE OWNERS OF THE PROPERTY DEPICTED ON THIS PLAT AND THAT ALL TAXES HAVE BEEN PAID AND THAT WE ADOPT THIS PLAT OF SUBDIVISION WITH OUR FREE CONSENT.

OWNER SIGNATURE \_\_\_\_\_ DATE: \_\_\_\_\_  
 OWNER SIGNATURE \_\_\_\_\_ DATE: \_\_\_\_\_

**SURVEYOR'S CERTIFICATION:**  
 AS REQUIRED BY SUBSECTION (D) OF O.C.G.A. SECTION 15-6-67, THIS PLAT HAS BEEN PREPARED BY A LAND SURVEYOR AND APPROVED BY ALL APPLICABLE LOCAL JURISDICTIONS FOR RECORDING AS EVIDENCED BY APPROVAL CERTIFICATES, SIGNATURES, STAMPS, OR STATEMENTS HEREON. SUCH APPROVALS OR AFFIRMATIONS SHOULD BE CONFIRMED WITH THE APPROPRIATE GOVERNMENTAL BODIES BY ANY PURCHASER OR USER OF THIS PLAT AS TO INTENDED USE OF ANY PARCEL. FURTHERMORE, THE UNDERSIGNED LAND SURVEYOR CERTIFIES THAT THIS PLAT COMPLIES WITH THE MINIMUM TECHNICAL STANDARDS FOR PROPERTY SURVEYS IN GEORGIA AS SET FORTH IN THE RULES AND REGULATIONS OF THE GEORGIA BOARD OF REGISTRATION FOR PROFESSIONAL ENGINEERS AND LAND SURVEYORS AND AS SET FORTH IN O.C.G.A. SECTION 15-6-67.

DAVID LEE JACHENS GA. R.L.S. # 3170 DATE \_\_\_\_\_

DATE OF SURVEY	03/04/2025
E.O.C. FIELD	1:15,000'
- ERROR/POINT	4"
ADJ. METHOD	OBSERVATION
E.O.C. PLAT	LINE
EQUIPMENT USED	TRIMBLE S6-R8 GNSS

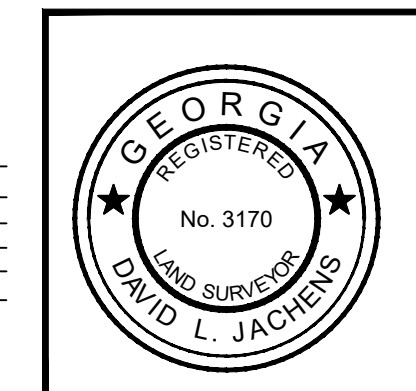

THIS SURVEY COMPLIES WITH BOTH THE RULES OF THE GEORGIA BOARD OF REGISTRATION FOR PROFESSIONAL ENGINEERS AND LAND SURVEYORS AND THE OFFICIAL CODE OF GEORGIA ANNOTATED (O.C.G.A.) 15-6-67 AS AMENDED BY HB0042016, IN THAT WHERE A CONFLICT EXISTS BETWEEN THOSE TWO SETS OF SPECIFICATIONS, THE REQUIREMENTS OF LAW PREVAIL.

- NOTES:**
1. THIS PLAT MAY NOT REFLECT ALL RECORDED OR UNRECORDED EASEMENTS. THIS PLAT DOES NOT REFLECT ALL IMPROVEMENTS OR ENCROACHMENTS.
  2. THIS PLAT IS SUBJECT TO ALL RECORDED EASEMENTS AND LOCAL BUILDING RESTRICTIONS. CONTACT YOUR LOCAL GOVERNING AUTHORITIES FOR CURRENT BUILDING SETBACK REQUIREMENTS. IT IS THE RESPONSIBILITY OF THE LAND OWNER TO VERIFY ALL WETLANDS THAT MAY BE PRESENT WITH THE U.S. ARMY CORPS OF ENGINEERS.
  3. THE CERTIFICATION, AS SHOWN HEREON, IS PURELY A STATEMENT OF PROFESSIONAL OPINION BASED ON KNOWLEDGE, INFORMATION AND BELIEF, AND BASED ON EXISTING FIELD EVIDENCE AND DOCUMENTARY EVIDENCE AVAILABLE. THE CERTIFICATION IS NOT AN EXPRESSED OR IMPLIED WARRANTY OR GUARANTEE.
  4. A PORTION OF LOT 1 LIES IN A FEMA FLOODPLAIN ZONE A & AE PER FEMA PANEL 13073C0140E DATED 06/07/2019.

A PLAT OF:  
**LOTS 1-6**  
**WILLIAM FEW PARKWAY**  
 PID: 059 138U & 059 138I  
 COLUMBIA COUNTY, GEORGIA  
 PREPARED FOR:  
**KIOKA LLC**

**JACHENS**  
**LAND SURVEYING, INC.**  
 Professional Land Surveying • GIS • Mapping

P.O. BOX 16  
 EVANS, GA 30809  
 PH 706.299.8721

PROJECT No.: 25007 FIELD DATE: 03/04/2025  
 DRAWN BY: DJL PLAT DATE: 08/04/2025  
 SCALE: 1"=100'