

IMPROVEMENT PERMIT (Valid for 60 months from date of issue) (Building permit cannot be issued unless CA is marked)

CONSTRUCTION AUTHORIZATION (Expires with Improvement Permit on: 10/05/2016)

This authorization is for a/n to a wastewater system.

Applicant/Owner: Chris Collins PIN#: 443900667198000 Zone: WF Acreage:

Property Description: Sanctuary at Vance Mountain Lot 29

Facility: Residential, 4 bedrooms Basement: Yes with fixtures

Design Flow: 480 gpd Water Supply: Existing Shared Well (off-site)

IMPROVEMENT PERMIT

CONSTRUCTION AUTHORIZATION

System: 25% Red. - Gravity Class: IIIg
Soil Depth: 42" Saprolite: 0 LTAR: 0.5 Slope: 30%
Repair: Drip - Pump TS-I Class: Vc
Repair Soil Depth: 30" LTAR: 0.25

Septic Tank: 1000 gal Pump Tank: Not Req'd
Trench Length: 240' & Spacing: 9' Min (On Center)
Trench Depth: 18" Max (Low Side) & Width: 36" Max
Distribution: Serial

Permit Conditions:

Do not disturb designated system areas. Divert all drainage from system areas. Maintain all setbacks. Do not bench
Installer is responsible for installing lines level and on contour.
House must be built to accommodate system and repair.

Diagram (Not to Scale)

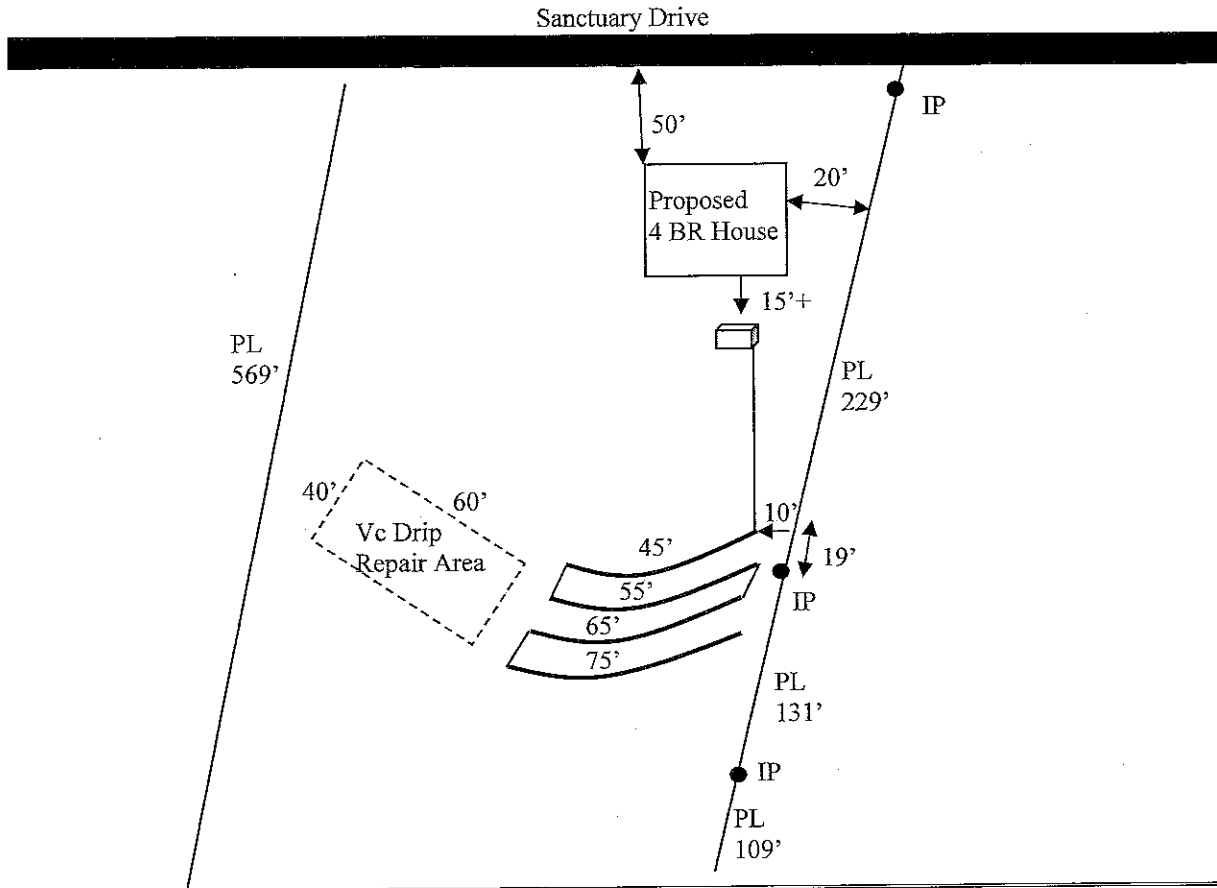

This permit/authorization is subject to revocation if the information submitted in the application is found to have been incorrect, falsified or changed, the site is altered, or intended use changes; is transferable; and is subject to the provisions of the Laws and Rules for Sewage System Collection, Treatment, and Disposal of the North Carolina Administrative Code. (By signing this document, I accept the specifications of this permit)

Date: 10/7/11

[Signature] Owner/Legal Reps. Signature

Issue Date: 10/05/2011

Trevor Peterson, REHS 2143 *[Signature]* Authorized State Agent