

Date Received	<b>State of Alaska</b> <b>Department of Environmental Conservation</b> <b>Documentation of Construction</b>	ADEC Review Date and Initial
---------------	---	------------------------------

**Part I. General Information**

Legal Description	Sunnybrook Phase IIA, Lot 5 Block 5	
Street Address	14706 N Sundown Drive	Tax/Parcel ID# 27556
Submitted By	<input checked="" type="checkbox"/> Registered Engineer <input type="checkbox"/> Approved Homeowner <input type="checkbox"/> Certified Installer No. CE 9135	
Installer Name Mailing Address, Email, & Phone	Newman's Hilltop Services, PO Box 98, Willow, AK 99688 newmans@mtaonline.net 907-495-6479	

**Part II. Wastewater Disposal**

Onsite Wastewater System Serves	<input checked="" type="checkbox"/> Single Family # of bedrooms <u>3</u> <input type="checkbox"/> Duplex Total # of bedrooms _____ <input type="checkbox"/> Small Commercial Facility with Estimated Design Flow of less than 500 gpd. - <u>show calcs below</u>	
<input type="checkbox"/> New System	<input checked="" type="checkbox"/> <b>Repair / Replace Existing Components (describe):</b> Replaced absorption area	
System Installed By:	<input type="checkbox"/> Certified Installer <input type="checkbox"/> Registered Engineer <input checked="" type="checkbox"/> Inspection by a Registered Engineer <input type="checkbox"/> Approved Homeowner (attach approval letter)	<b>Installation Notification Date</b> <b>Date Installed</b> 8-21-24
Septic Tank	Size <u>* 1250</u> # of Compartments <u>* 2</u> Material <u>* Steel</u> Manufacturer <u>* Anchorage Tank</u> Lift Station Manufacturer <u>N/A</u> Alarms <input type="checkbox"/> Yes <input type="checkbox"/> No	
Type of Soil Absorption System	<input type="checkbox"/> Deep Trench <input type="checkbox"/> Shallow Trench <input type="checkbox"/> Seepage Pit <input type="checkbox"/> Bed <input type="checkbox"/> Mound <input type="checkbox"/> Infiltrators (# of Units _____ Unit Area _____ sq. ft.) <input checked="" type="checkbox"/> Other "Five-wide" trench	
Soils	Classification <b>SW</b>	Rating - sq ft/bedroom <b>150</b>
Soil Absorption Area	Field Dimensions (Length <b>45</b> ft Width <b>5</b> ft Thickness/Depth of Rock <b>4</b> ft)	
	Effective Absorption Area <b>450 SF</b> Size of Rock <b>1 1/2" to 3"</b>	
Perc Test Results	Minutes per Inch _____ Application Rate _____ sq ft / bedroom Performed By _____ (Attach results - sealed and signed by a registered engineer)	
Ground Cover Over	Septic Tank <u>* &gt;4</u> ft Insulation Thickness _____ in	Absorption Area <u>&gt;4</u> ft Insulation Thickness _____ in
Cleanout Pipes/Caps	# Cleanout(s) <b>1</b>	# Septic Tank Vents <b>2</b> # of Leach Field Monitor Tubes <b>1</b>
<b>Separation Distances from septic tank or absorption area, whichever is closest, to all nearby</b> Public drinking water sources <u>N/A</u> ft. Class <u>N/A</u> Private drinking water sources <u>&gt;105</u> ft Nearest water bodies (see 18 AAC 72.020(b)) <u>N/A</u> ft    Lot Line <u>&gt;10</u> ft		
<b>Separation Distances from On Lot Sewer Lines to Drinking Water Sources - Public</b> <u>N/A</u> <b>Private</b> <u>&gt;25'</u>		
<b>Separation Distances from Bottom of Distribution Rock to - Groundwater Table</b> <u>&gt;4'</u> <b>Impermeable Soils</b> <u>&gt;6'</u>		
<b>Separation Distance from Absorption Area to Slope exceeding 25%</b> <u>&gt; 50'</u>		
<b>Comments / Recommendations / Criteria used to size commercial facility:</b> * = Information from DEC Key # 36858 installed 5-15-10. Previous design was a 4 bedroom system. Now only 3 bedrooms.		
<b>I certify that the above information, and that provided in Section III, is correct:</b>		
Signature	<i>William Klebesadel</i>	Printed Name <b>William Klebesadel</b>
Title, Reg/Cert No, Inst No.	<b>CE 9135</b>	Date <b>10-30-24</b>



NOTE: Must be signed by a Certified Installer, DEC staff or Approved Homeowner. If engineering seal bears printed name, registration number and is signed, those blocks need not be completed for engineered submittals. Do not modify this form.

# SEPTIC SYSTEM PLAN VIEW

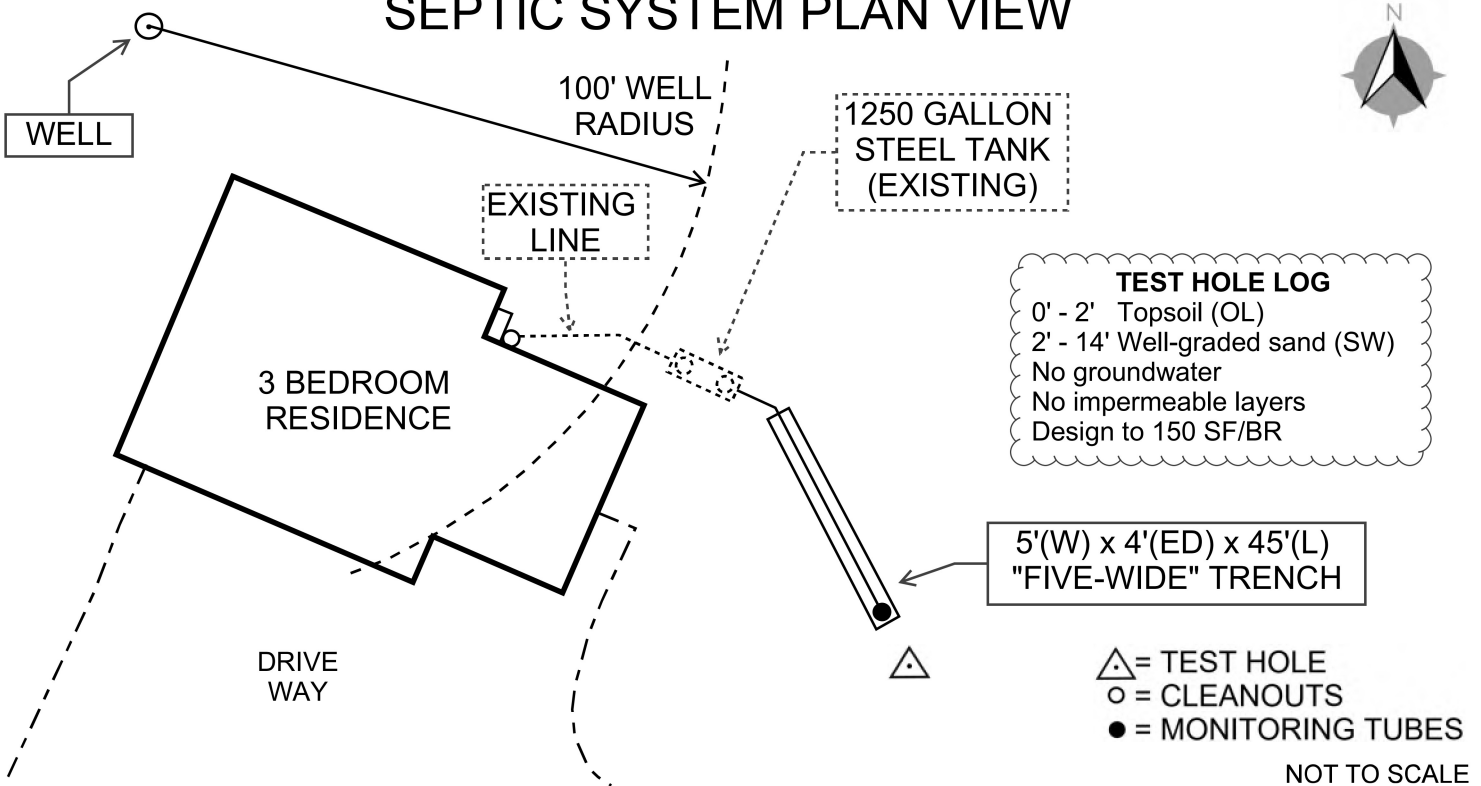

# SEPTIC SYSTEM PROFILE

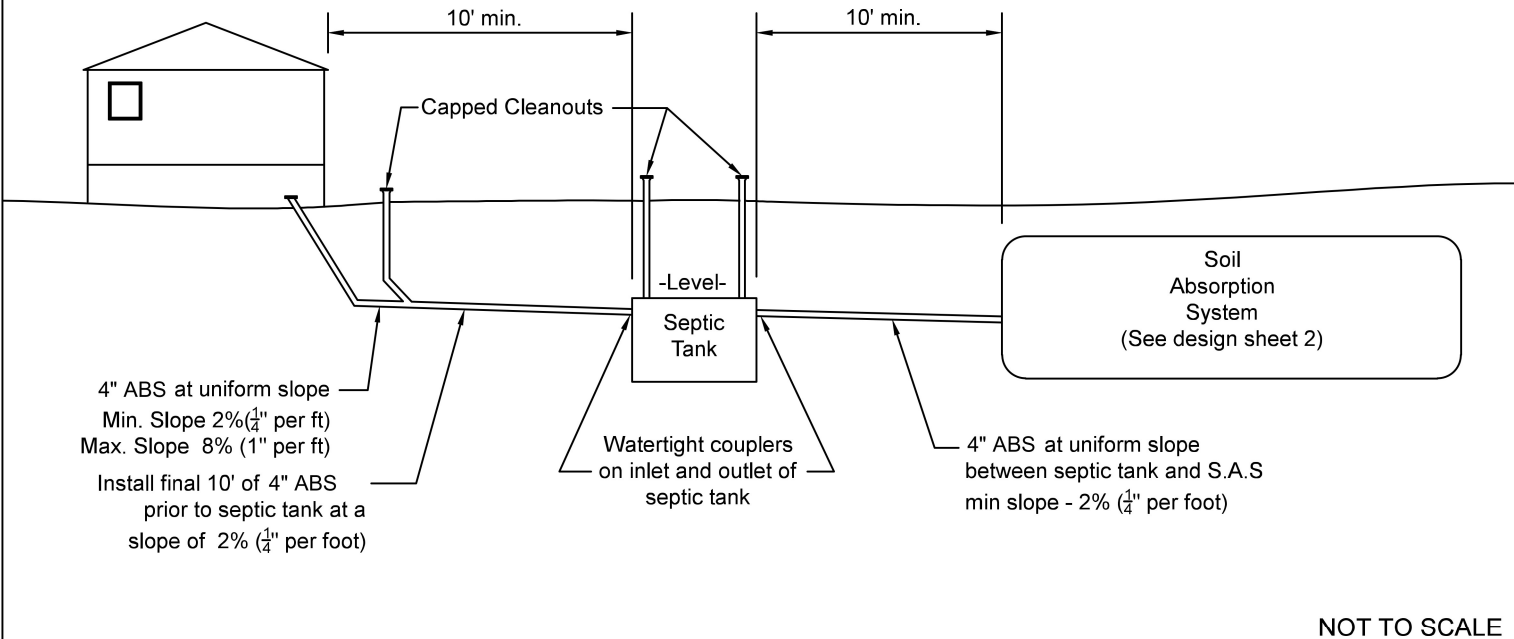

## Conventional Single Family Residential SEPTIC SYSTEM AS-BUILT

LEGAL DESCRIPTION: Sunnybrook Phase IIA, Lot 5 Block 5

**RECORD DRAWING**

This record drawing represents the as-constructed condition of the improvements documented above. Based on periodic visual observations and information obtained from the installer, this data appears reasonable and represents that the project was constructed in general conformance with current 18 AAC 72 regulations and ADEC policies.

PIONEER ENGINEERING LLC

SHEET 1 OF 2

COMPLETED DATE 8-21-24

**"FIVE-WIDE" PLAN VIEW**

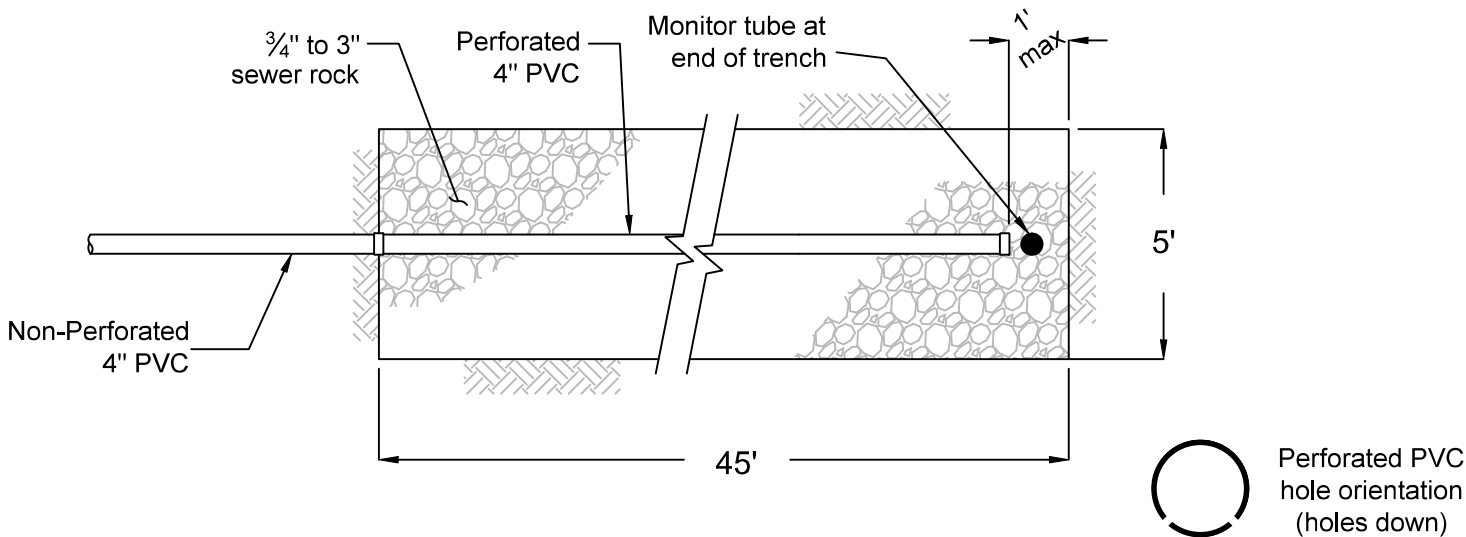

**TRENCH SECTION**

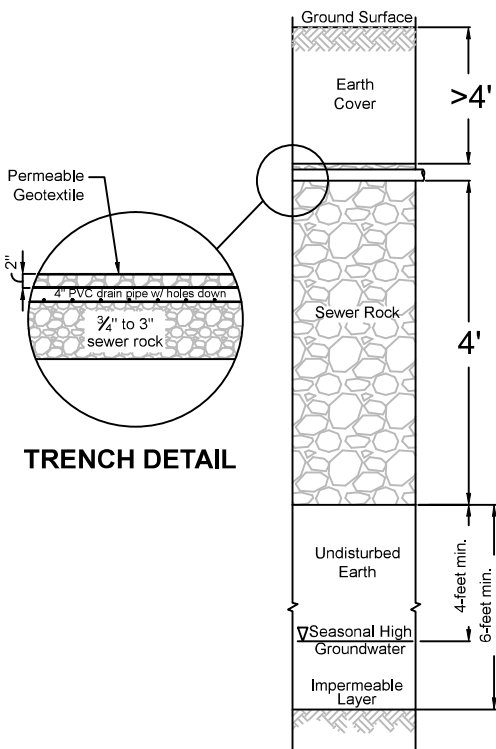

**MONITOR TUBE DETAIL**

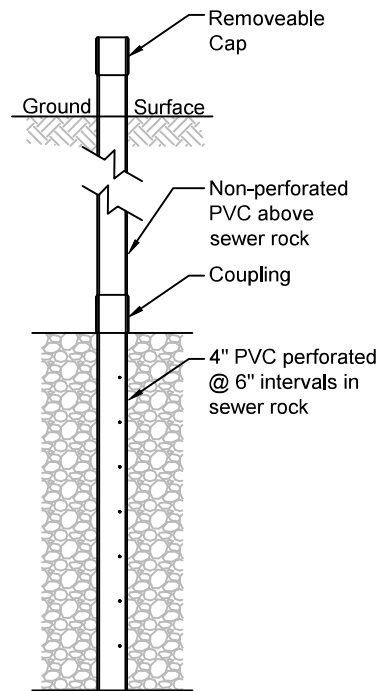

NOT TO SCALE

**Conventional Single Family Residential SEPTIC SYSTEM AS-BUILT**

LEGAL DESCRIPTION: Sunnybrook Phase IIA, Lot 5 Block 5

**RECORD DRAWING**

This record drawing represents the as-constructed condition of the improvements documented above. Based on periodic visual observations and information obtained from the installer, this data appears reasonable and represents that the project was constructed in general conformance with current 18 AAC 72 regulations and ADEC policies.

PIONEER ENGINEERING LLC

SHEET 2 OF 2

COMPLETED DATE 8-21-24

