

# *Panoramic Ridge*

*Luxury Living, Naturally Elevated*

All Builders and Private Parties Welcome



## *Welcome to Panoramic Ridge!*

Where 13 exclusive lots offer a rare blend of luxury and natural beauty high above Anchorage. Each homesite captures either a sweeping views of the inlet, city lights, or surrounding mountains, an ideal backdrop for your custom-built dream home.

Find tranquility, outdoor adventure, and a daily connection to nature in the lifestyle that Panoramic Ridge delivers. At Panoramic Ridge, the Potter Highlands Walking Trail is just outside your future front doorstep.

This scenic path winds through peaceful forest, offering unobstructed views of the mountains and inlet. Whether you're out for a daily walk or a quiet moment in nature, the trail offers a direct connection to the beauty that surrounds you.





## *Step Away from the City Into Serenity*

Just minutes away, Potter Marsh is one of Anchorage's most scenic and accessible wildlife experiences. Stroll along a 1,500 ft boardwalk through wetlands alive with birds, spawning salmon, and the occasional moose. Lace up your skates, it's time to hit the ice this winter!

Located along the Seward Highway, enjoy the view up the paved Potters Valley Road with mountain and inlet views from every turn. One of the few roads with triple designation: a USDA Forest Service Scenic Byway, an Alaska Scenic Byway, and an All-American Road.



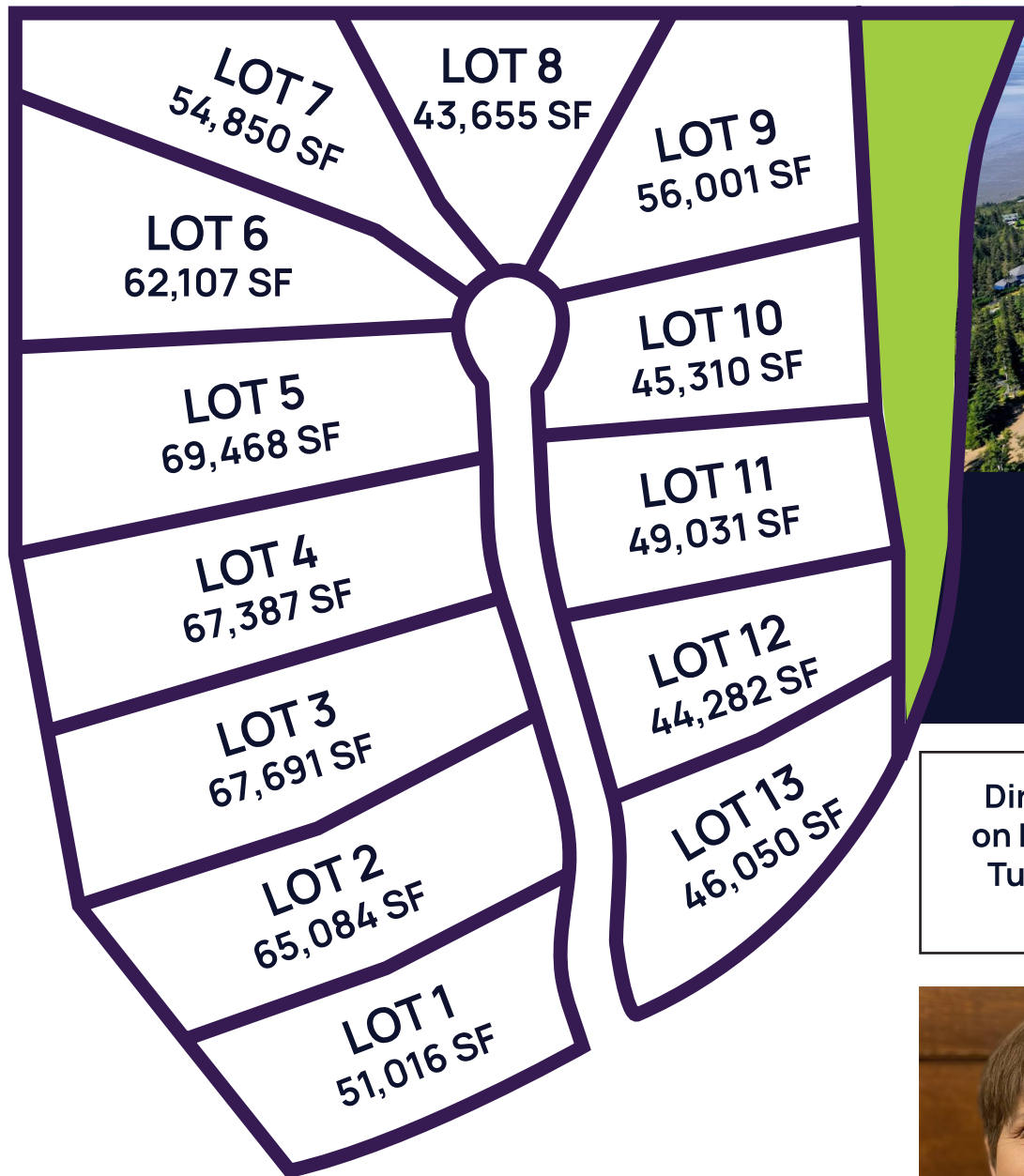

## *Panoramic Inlet & Mountain Views!*

Directions: New Seward Highway south. Turn left on Potter Valley Road (just south of Potter Marsh). Turn left on Potter Highlands Drive, follow to end of pavement. Property is on your right.

**Connie Yoshimura**  
**907-229-2703**  
**connie@bhhsalaska.com**



**BERKSHIRE  
 HATHAWAY**  
 HOMESERVICES  
 ALASKA REALTY