



- NOTES:
1. ALL WASTEWATER DISPOSAL SYSTEMS SHALL COMPLY WITH EXISTING LAWS.
 2. 1/2" X 2" REBAR SET AT ALL LOT CORNERS.
 3. ALL BLOCK RETURNS ARE 25' R UNLESS NOTED OTHERWISE.
 4. A 20' BLDG. SETBACK LINE EXISTS ALONG ALL ROAD ROW.
 5. BASIS OF BEARING IS N 89° 59' 00" E BETWEEN THE SEC. COR COMMON TO S. 33, 34, 3 & 4 AND THE WEST 1/8 COR. COMMON TO S. 3 & 34, AS PER SKILL HILL SUBD.
 6. ALL LOT LINES IN BLOCK 3 SHALL EXTEND TO THE RIGHT BANK OF DEEP CREEK.
 7. LOTS IN BLOCK 3 MAY BE SUBJECT TO A SEASONAL HIGH WATER TABLE.
 8. DISTANCES SHOWN ARE TO WITNESS CORNERS AND NOT TO THE STREAM BANK.
 9. THE 20' BLDG. LINE SHALL ALSO SERVE AS AN UNDERGROUND UTILITY ESMT.

CURVE DATA

NO.	ANGLE	RADIUS	LENGTH	TANGENT
1	49° 00' 00"	1200.00	942.48	497.06
2	77° 45' 00"	300.00	375.68	216.96
3	34° 45' 00"	300.00	181.95	93.87
4	28° 30' 00"	500.00	250.02	127.68
5	58° 30' 00"	500.00	511.24	280.49
6	49° 00' 00"	300.00	235.62	124.26

SPAKIONAYA VISOK SUBD.
(SILENT HEIGHTS)

CERTIFICATE OF OWNERSHIP
 WE HEREBY CERTIFY THAT WE ARE THE OWNERS OF THE PROPERTY SHOWN AND DESCRIBED HEREON. WE HEREBY REQUEST APPROVAL OF THIS PLAT SHOWING SUCH EASEMENTS FOR PUBLIC UTILITIES, ROADWAYS, AND ALLEYS INDICATED BY US FOR PUBLIC USE.
Robert Hastings *Christina Wilson*
 ROBERT HASTINGS CHRISTINA WILSON
 217 FURNACE ANCHORAGE, ALASKA 2674 FURNACE ANCHORAGE, ALASKA

NOTARY'S ACKNOWLEDGEMENT
 SUBSCRIBED AND SWORN BEFORE ME THIS 9th DAY OF Sept 1976.
Dr. Michael Francis March 3, 1979
 NOTARY PUBLIC FOR ALASKA MY COMMISSION EXPIRES

SURVEYOR'S CERTIFICATE
 I, THE UNDERSIGNED REGISTERED SURVEYOR, HEREBY CERTIFY THAT A LAND SURVEY HAS BEEN COMPLETED BY ME OR UNDER MY DRECT SUPERVISION AND THAT CORNERS AND MONUMENTS HAVE BEEN LOCATED AND ESTABLISHED AND THAT DIMENSIONS SHOWN HEREON ARE TRUE AND CORRECT.
Jerry Anderson 9-5-76
 JERRY ANDERSON, 3686-3

PLAT APPROVAL
 PLAT APPROVED BY THE BOROUGH PLANNING COMMISSION THIS 12th DAY OF July 1976.
Don Ed & Selman
 BOROUGH MARK

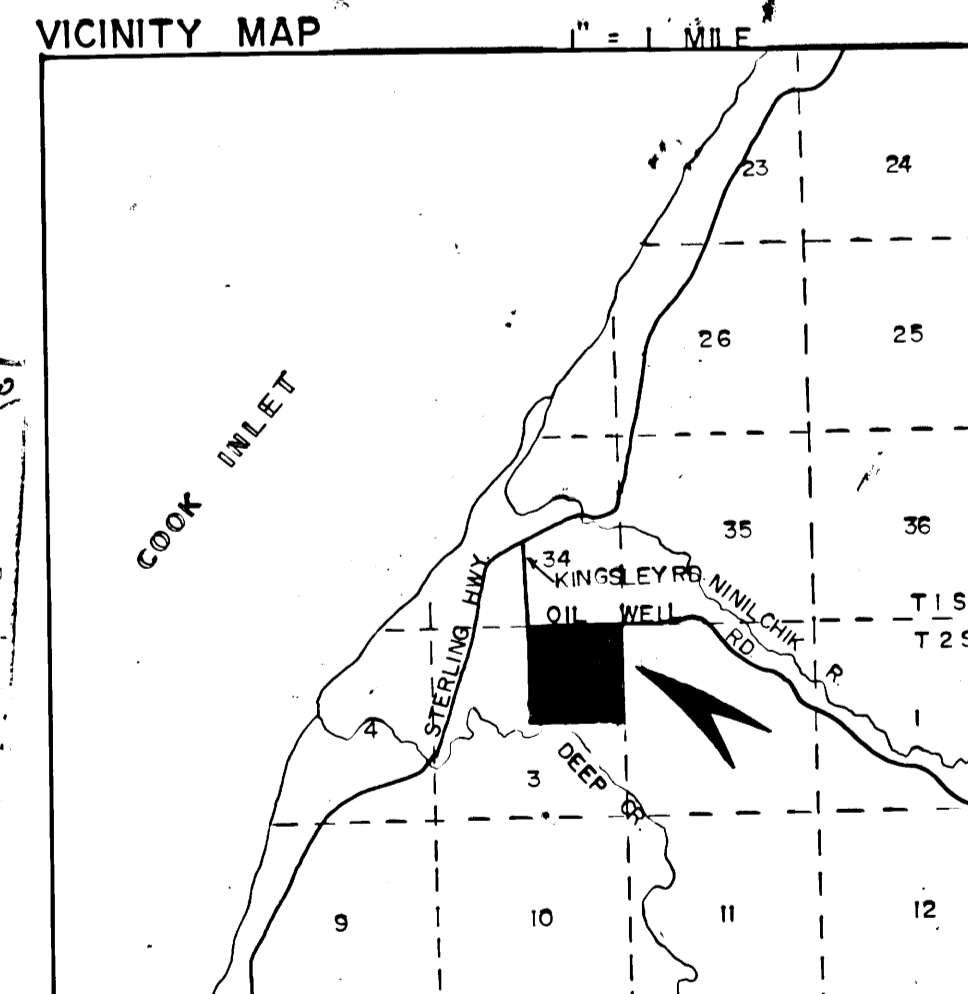

DATE: JUNE, 1976
 SCALE: 1" = 100'
 CHECKED BY: R.H.
 DESIGNED BY: J.A.
 DRAWN BY: S.W.
 FLD. BK. NO.: 8

DEEP CREEK ESTATES
 SITUATED IN THE NE 1/4, S 3, T 2 S, R 14 W, S.M.
 CONTAINING 787.743 ACRES

ABILITY SURVEYS
 JERRY ANDERSON, L.S. BOX 1263 HOMER, ALASKA

HP 76-84

FND. WC. C 1/4, GRANITE STONE, 268-5, 1962

SET C 1/4 WC, 3/4" IP WITH PLASTIC CAP

CE 1/8" S 1 SET SECTION

UNSUBD.

1/4 COR. FND. GLO. MON. CAP MISSING